

# Phase II Geometry

Oliver Hitchcock

# Plan



- In progress



- Completed

1. Study Phase I geometry

2. Obtain PDSF account?

3. Obtain personal install of BACCARAT (compile and test geometry)

a. Run “make project” (starts a new geometry project and sets up the initial files)

i. Make project NAME=“Phase\_II\_Geometry”

1. Will create new directory, messenger skeleton, detector, and materials class

4. Create Phase II geometry

a. Shaun: Phase II drawings?

b. Compile list of classes needed

# Phase I Geometry: **Reverse Field Region(RFR)**

1)

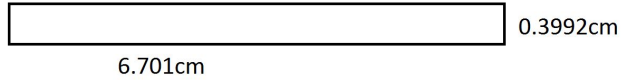

2)

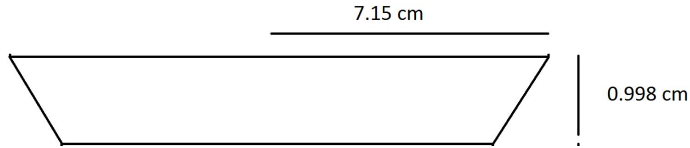

3)

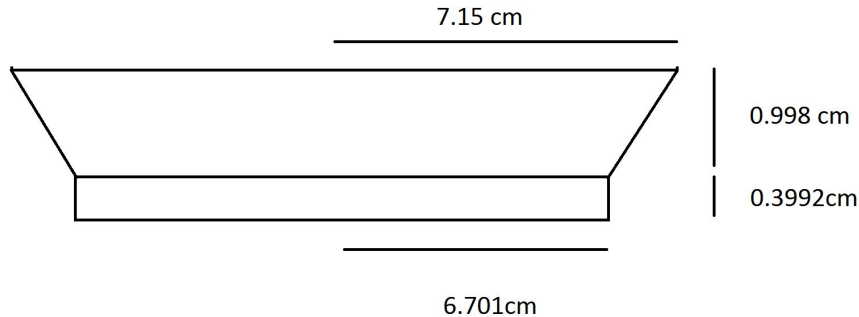

# Phase I Geometry: **Reverse Field Region (RFR)**

4-9) Adding more cylinders and cones to create single solid RFR

10) Fill this “solid” volume with LXe to get a “logical” volume:

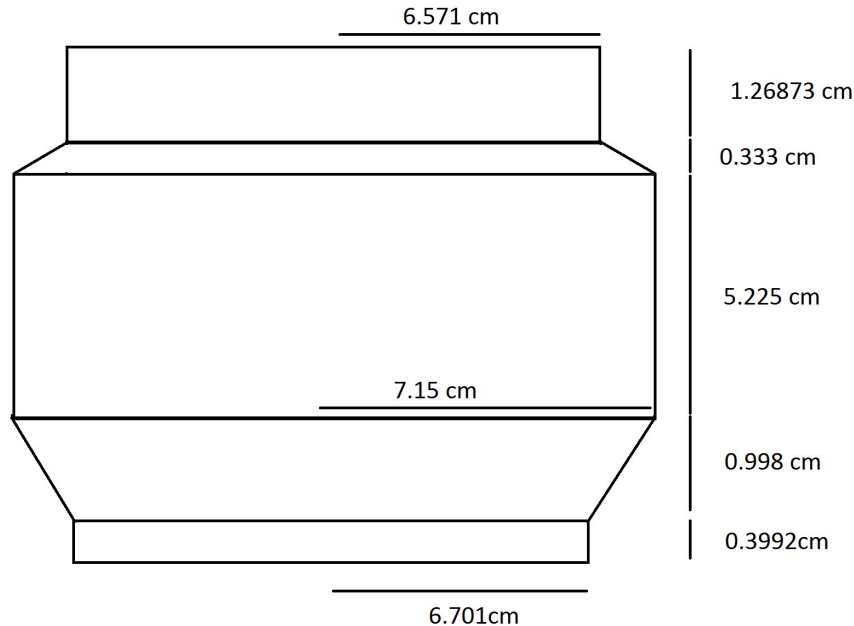

# Phase I Geometry: **FFR**

1-7) Same Procedure as RFR to obtain a single “solid” FFR

8) Fill this “solid” volume with LXe to get a “logical” volume:

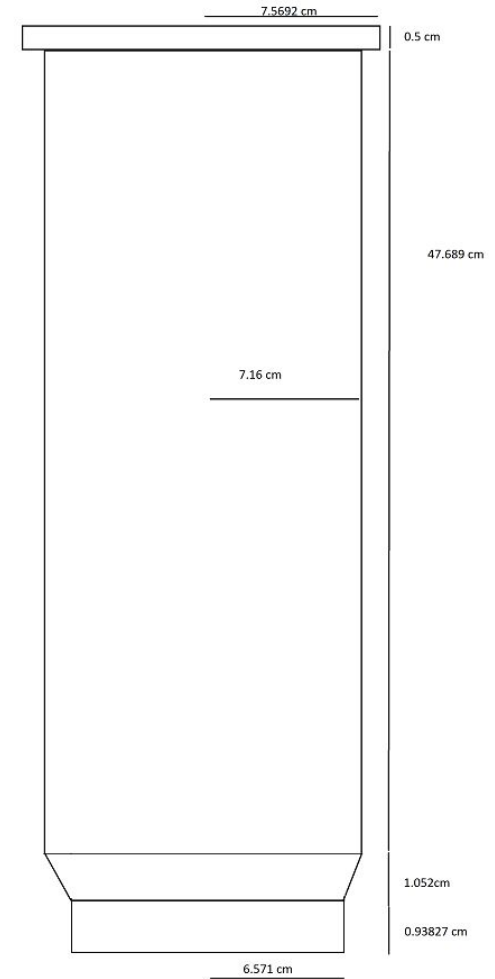

# Phase I Geometry: FFR + RFR

- Noticed the top of RFR matched with bottom of FFR
- Added them together to get:
- Compared to CAD section view:

